

Clamp Gaskets

Specifications

- PSI Service Ratings for the sanitary clamps DO NOT APPLY to connections (1" and above) using any PTFE gaskets, due to the potential for cold flow under normal operating conditions. PTFE gaskets, when used with any clamp, are likely to leak at pressures far below the published service ratings. This restriction does not apply to the fractionally sized 1/2" and 3/4" connections, due to their recessed, fully contained design.

Approval

- Gasket material approved by  (3A), USDA and complies with FDA's 21CFR177.2600 and 1550

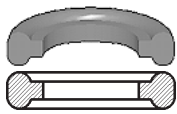

Mini

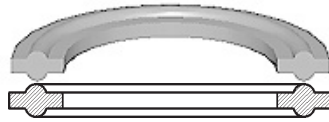

Standard - type 1

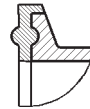

Flanged - type 2

Clamp Gaskets - Black



Type 1 - Standard
1" and larger



Type 1 - Standard
1/2" - 3/4"

Feature

- Color code: one red dot

Approval

- Meets 21CFR 177.2600

Size

1/2"
3/4"
1"
1-1/2"
2"
2-1/2"
3"
4"
5"
6"
8"

Nitrile Rubber Part

42MP-U50
42MP-U75
40MP-U100
40MP-U150
40MP-U200
40MP-U250
40MP-U300
40MP-U400
40MP-U500
40MP-U600
40MP-U800

Clamp Gaskets - White



Type 1 - Standard
1" and larger



Type 1 - Standard
1/2" - 3/4"

Feature

- Color code: one red dot

Approval

- Meets 21CFR 177.2600

Size

1/2"
3/4"
1"
1-1/2"
2"
2-1/2"
3"
4"
6"

Nitrile Rubber Part

42MP-UW50
42MP-UW75
40MP-UW100
40MP-UW150
40MP-UW200
40MP-UW250
40MP-UW300
40MP-UW400
40MP-UW600

Clamp Gaskets - Black



Type 1 - Standard
1" and larger



Type 1 - Standard
1/2" - 3/4"

Features

- Color code: three green dots
- Peroxide cured

Approvals

- Meets 21CFR 177.2600
- Passed U.S.P. Class VI Cytotoxicity testing

Size

1/2"
3/4"
1"
1-1/2"
2"
2-1/2"
3"
4"
5"
6"

EPDM Part

42MP-E50
42MP-E75
40MP-E100
40MP-E150
40MP-E200
40MP-E250
40MP-E300
40MP-E400
40MP-E500
40MP-E600

Visit dixonvalve.com for sizing charts.